

Memo to: Board of Education

From: Stephen R. Johns, Ed.D.
Business Manager

Date: April 13, 2012

Re: ISBE Maintenance Grant Program

I recommend that the board approve the district's \$50,000 application for the ISBE School Maintenance Grant Program. The grant is part of the Illinois Jobs Now! Capital Program. If the district's grant is approved, the grant would pay \$50,000 toward the estimated cost of \$113,324 to replace Roof C at Millburn Central School.

ROOF AREAS

- A - MODIFIED BITUMEN MEMBRANE WITH ALUMINIZED COATING - 10,230 S.F.
- B - MODIFIED BITUMEN MEMBRANE WITH ALUMINIZED COATING - 6,770 S.F.
- C - MODIFIED BITUMEN MEMBRANE WITH ALUMINIZED COATING - 5,340 S.F.
- D - FULLY ADHERED EPDM MEMBRANE - 6,560 S.F.
- E - BALLASTED EPDM - 1,550 S.F.
- F - MODIFIED BITUMEN MEMBRANE WITH ALUMINIZED COATING - 300 S.F.
- G - BALLASTED EPDM - 3,630 S.F.
- H - BALLASTED EPDM - 10,463 S.F.

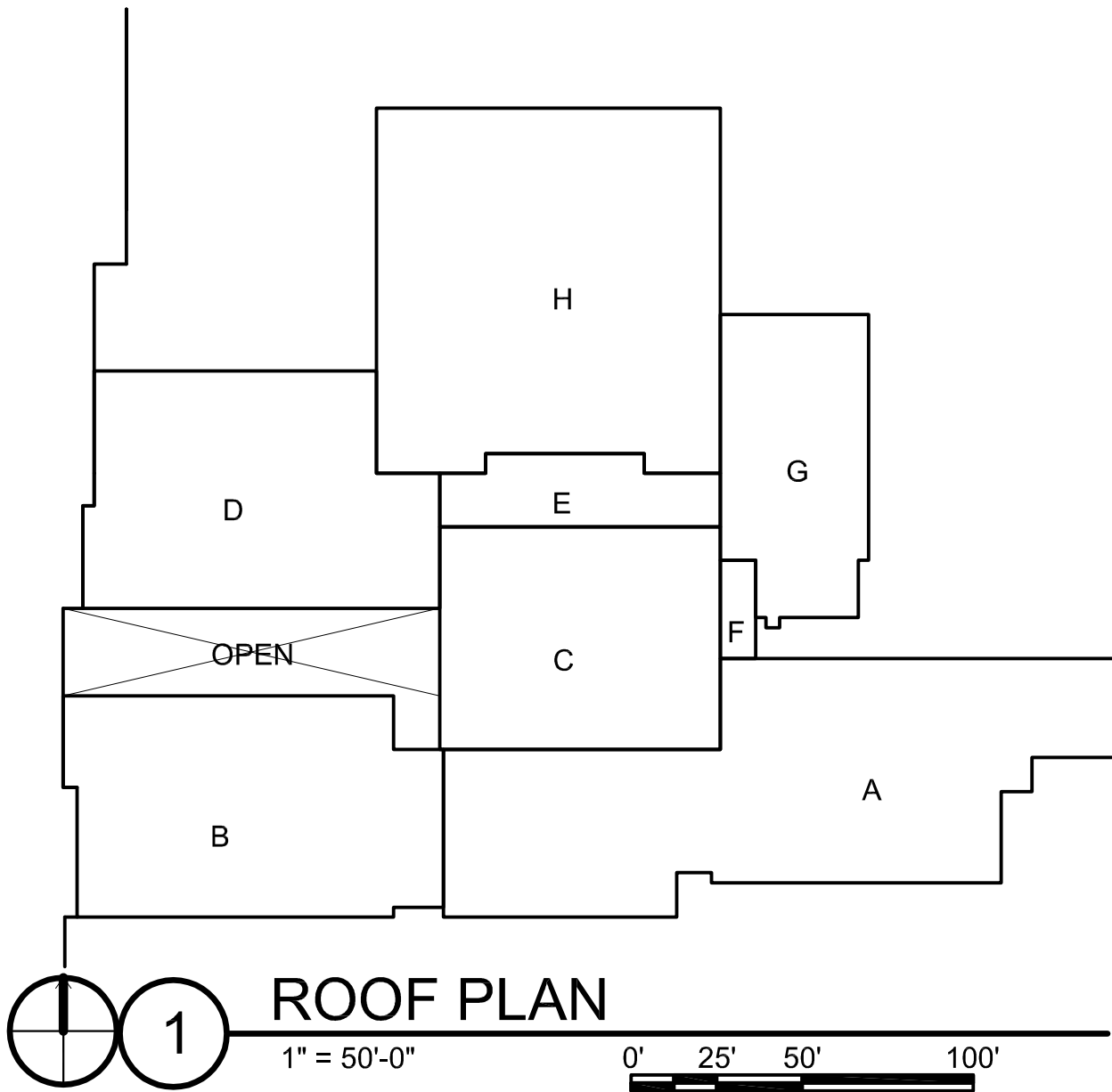

© 2012 GREENASSOCIATES, INC.

GREEN ASSOCIATES
ARCHITECTURE
CONSTRUCTION SERVICES

111 Deerlake, Suite 135
Deerfield, Illinois 60015
Telephone 847-317-0852
Facsimile 847-317-0899

MILLBURN SCHOOL
MILLBURH C.C.S.D. 24
18550 MILLBURN ROAD
OLD MILL CREEK, ILLINOIS

ROOF PLAN

Drawn	Checked
ID	CM
Issue Date	11 APR 2012
Project Number	1365 MISC
Sheet	

A-01